



INSTRUCTION MANUAL

JUICER MIXER GRINDER

Model No- JMG 3274

USHA care

Toll free
1800-1033-111

Email: usha_care@ushainternational.com
<http://www.facebook.com/ushainternational>

USHA INTERNATIONAL LTD.

Plot No.15, Institutional Area, Sector 32, Gurgaon - 122 001 (Haryana) Tel : +91-124-4583100, Fax : +91-124-4583200
E-mail : corporate@ushainternational.com Website : www.ushainternational.com
Regd. Office : Surya Kiran Building, 19 Kasturba Gandhi Marg, New Delhi (India) Tel : +91 11 23318114 Fax : +91 11 23318118

ISO 9001: 2008
Certified Company



Fans • Sewing Machines • Home Appliances • Engines & Pumpsets • Electrical Motors & Pumps • Water Coolers & Dispensers
• Inverters • Cook Tops, Hobs & Hoods • Auto Components

USHA © Registered Trademark and Copyright of USHA INTERNATIONAL LTD.  © Registered Trademark of USHA INTERNATIONAL LTD.



Dear Customer,

Congratulations!

You are now the proud owner of Usha Juicer Mixer Grinder.

Innovatively designed, using only the highest quality material and components, your Usha Juicer Mixer Grinder is designed for years of trouble free performance.

Please read this Instruction Manual carefully before using and keep it cautiously after reading for future reference.

Best Wishes



WARRANTY CARD

This appliance is warranted for 1 year on product against all manufacturing defects from the date of sale. In the event of any complaint, please contact Usha Care at Toll Free No. 1800 1033 111.

The warranty is valid only when:

- 1) The appliance has been installed, used and maintained in accordance with the instruction manual.
- 2) The warranty card and cash memo duly signed by the authorized dealer are presented with the complaint.
- 3) The appliance has not been opened or tampered with, by any unauthorized person.

This warranty does not apply for:

- 1) Damages due to chipping, peeling, plating and denting.
- 2) Breakage or damage to components made out of Bakelite, Urea, ABS, SAN and such plastic materials, rubber parts and cord.
- 3) Normal wear and tear of parts.
- 4) Damage resulting from accidents, mishandling or negligence on part of the customer.

Liability for consequential loss or damage is neither accepted nor implied.

S.NO: _____

CASH MEMO _____ DATE: _____

DEALER'S NAME AND ADDRESS: _____

OWNER'S NAME & ADDRESS: _____

1. This machine should not be used by unresponsive or psychopathic person and children. Children should be overseen, so it can be testified that they are not playing with it.
2. Before using, put this machine on a stable and even table board, operate according to the methods mentioned.
3. Before juicing, first confirm juicing net and rotor clutched in position, and no hard contact between juicing net cutter and transparent cover. Put the transparent cover on, fasten the handle, then turn on the machine
4. Before being used, the motor works in running-in phase, there may be slight peculiar smell and spark, this is normal, after the motor works for some period, the above phenomenon will disappear.
5. During juicing, make sure there is not too full juice and residue and residue in the middle seat and residue cup, if too full, please cut off power supply, clean up, then use again.
6. During using, do not open the cup cover. In case power supply is on, do not put hand or any ware into the mixing cup or feed port, otherwise, harmful accident may occur or this machine may be damaged.
7. In order to prolong service life of this machine, over-temperature protective device is mounted in the motor, if the motor works for a long time or overloaded, when over warning temperature, power supply will automatically cut off. After the motor stops, pull out plug of power supply, wait for the motor to cool (about for 30 min), use again.
8. All fittings are strictly prohibited from disinfecting in high temperature disinfection cabinet or steaming and boiling for disinfection.
9. During operating, Please do not leave, never let children operate this machine.
10. When this machine works in mixing, mincing or grinding conditions, no-loaded or over loaded work is strictly prohibited.
11. After operation, do not pour the food out until pull out the plug of power supply
12. Cutters are very sharp, in order to avoid danger, when cleaning a cutter, please put the cutter under water tap for washing, do not wash it with hand.
13. This machine must not be used for others beyond regulated purposed.
14. In case of damaged power supply cord, in order to avoid danger, replacement must be performed by the company authorized service centre or its service representative. In case of fault, do not disassemble the machine by yourself, please contact Usha authorized service centre.

DIAGRAM OF JMG AND POSITION OF MAIN COMPONENTS

NOTES

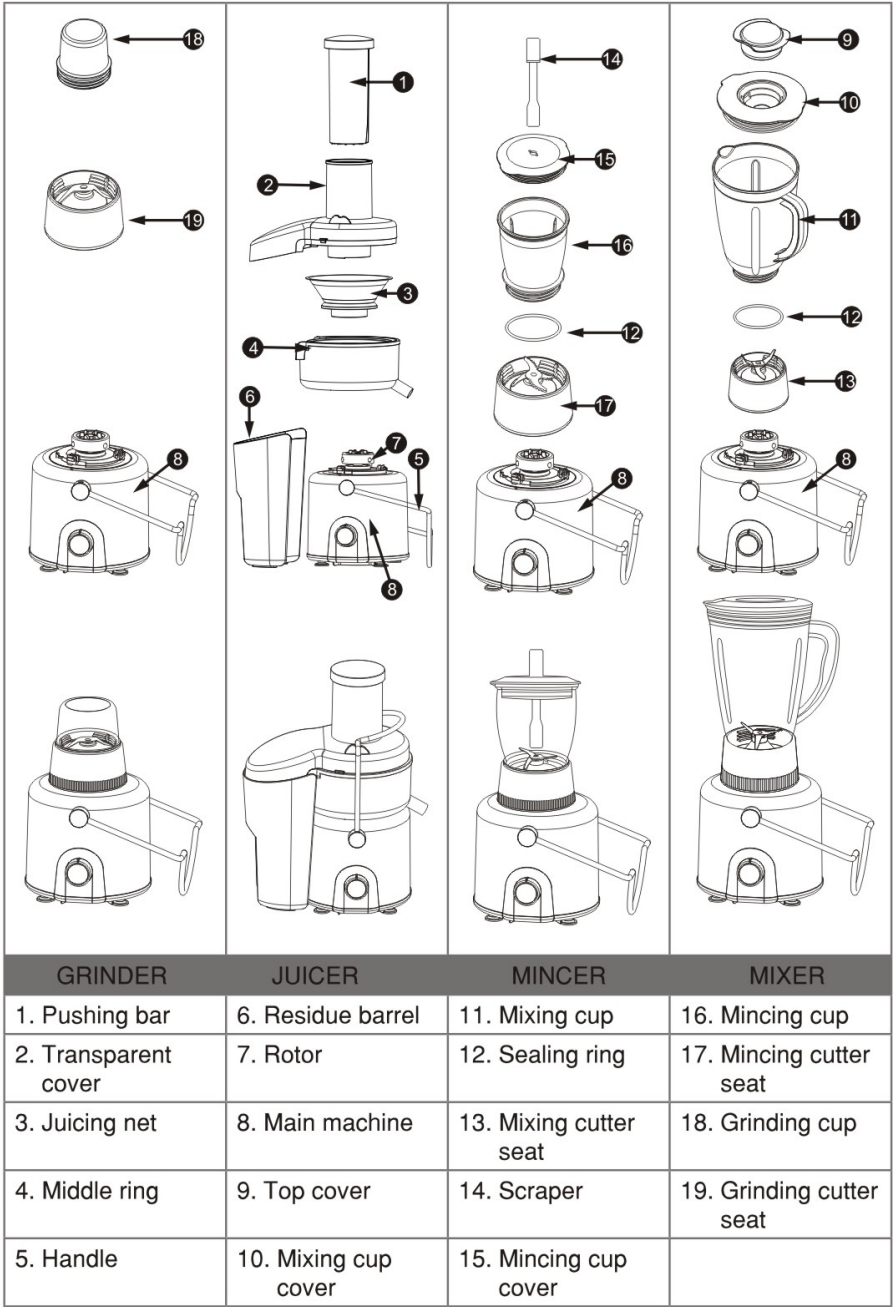

OPERATING TIME

This machine is designed with button switches of O grading, I grading, II grading and * inching (O for stop, I for weak grading, II for strong grading, and for * inching). For Mincing, cutting up and grinding, select inching and strong grinding, for operating time, take the principle of running for 10s and stopping for 5s, after using for 1 min, stop for 1 min, then use again. For mixing vegetable, fruit, soy milk, select inching or strong grading, for mixing egg. Select weak grading. For juicing select strong grading, for operating time, after operating for 1 min, stop for 1 min then use again. After the above operation is performed for three times, stop for 15 min, do not operate until the motor is cooled, in this way, service life of this machine will be prolonged, the machine will serve you more efficiently.

MAINTENANCE AND CLEANING

1. This machine shall be often used, so as to keep the motor dry and clean,
2. If not using for a long time, please store this machine at a dry and well ventilated place so as to prevent the motor from being damped and going moldy.
3. No washing the main machine. When cleaning, only wipe with wet cloth. Other components may be washed directly with water, such as pushing bar, cover, middle seat, residue cup, juice nozzle cover.
4. Every month, remove the cutter rest of mixing cup, mincing cup and grinding cup, drop a little edible oil into the cutter shaft and bearing in order to ensure lubrication.
5. For cleaning the mixing cup, fill some warm water and soft detergent, mount on the main machine, put the cover on, press the switch to mix for 30s, then wash with clean water.

TECHNICAL SPECIFICATIONS

Voltage	220-240V AC
Frequency	50 Hz
Wattage	700W

MAIN FEATURES

1. This machine serves the functions of juicing, mincing, grinding, mixing, and blending.
2. High-Design, simple, and beautiful with combined structure, easy to operate and clean.
3. High speed electric motor with overheating protection is adopted, high efficiency, time saving and high service life of the motor,
4. Safety lock unit for switching is specially designed, in order to make sure safety and reliability in use

ATTENTION BEFORE USING

1. This machine is set with safety unit, when the handle does not fasten the cover or the cutter seat is not fastened, the motor cannot turn, so as to ensure safety for the user.
2. When disassembling or assembling the juicer, press the upper of feed port of the cover with your hand, then force the handle to slide in or out of cover slot.
3. When disassembling juicing net, first remove the cover and residue barrel, then turn the middle ring up to 30 degrees by holding juicing nozzle with your hand, and take up, the juicing net will automatically leave the rotor.
4. In order to avoid damage, before using, first check power supply for compliance with rated voltage.
5. Clean all parts able to disassemble (refer to the section of “maintenance and cleaning”).
6. When assembling, please carefully read the diagram.
7. Please carefully read the “attentions” before using.

JUICING

1. Before using, please confirm the button switch of the main machine in stop state, in this way, in case assembly is not completed, starting the main machine can be avoided, so unnecessary damage for persons or property avoided.

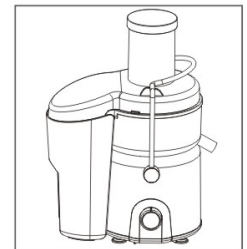

- Before juicing, first confirm juicing net and rotor clutched in position, and no hard contact between juicing net cutter and transparent cover, put the transparent cover on, put the handle into the cover slot, then turn on the machine.
- For using, assemble according to the diagram of "name and position of main components". Turn on power supply, press switch to let the machine run no-load for 5 sec. Put prepared vegetable or fruit into feed port of the juicer, Press with the pushing bar, evenly, hard and slowly, juice of the vegetable or fruit can be found, original, fresh, good for health.
- For the juicer with large diameter, entire apple or pear can be put in for juicing, no cutting apart needed, easy and quick, Note: when pressing food with the pushing bar, force shall be even or indirect, pressing force shall not be more than 1 kg, no too sudden force, otherwise, juicing effect will be reduced.

MIXING

- First check the position switch in stop state (the switch shall be in stop position)
- Put sealing ring into cutter seat slot, screw and fasten mixing cup into cutter seat (clockwise for fastening, and counterclockwise for loosening), put the mixing cup cover and the feed cover on.
- Clockwise screw the cutter seat into the main machine with your hand (counterclockwise for loosening), no holding the cup with your hand for disassembling, otherwise, the cup will leave the cutter seat make food in the cup leak out.



EGG MIXING

- Put egg without eggshell into the mixing cup, pour appropriate cool boiled water, add some flour. Put and fasten the cover, press the button of weak grading for 1 min.

VEGETABLE OR FRUIT MIXING

For vegetable or fruit to be mixed, after peeling or shelling, and pitting, cut it into blocks or sections, every time put 250g to 350g to, pour appropriate cool boiled water, perform assembly according to assembling for use, turn on for mixing.

MEAT MINCING

- Screw mincing cup into cutter seat (clockwise),
- For meat to be processed, remove tendon, bones and skin, and wash cleanly, cut into small piece or 2 centimetre squares, every time put 200g into the mincing cup, put the cup cover on the mincing cup, mount them on the main machine according to the position shown in the diagram, turn clock wise, press tight the mincing cup with your hand, turn on the button switch for mincing,
- During mincing, pouring some edible oil or flavouring will produce better results.

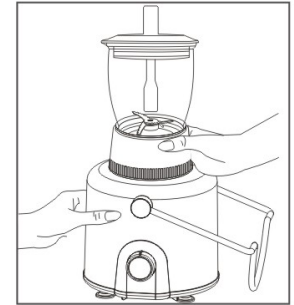

Note: if rotating speed slows down abruptly due to too much meat quantity of tendon entangling blade, please turn down the machine, cut off power supply, and adjust meat quantity or remove tendon.

GRINDING

- Grinding cup is applicable to dried food to be ground into powder during using, every time put 150g into the grinding cup, cover with grinding cutter seat, fasten tight clockwise, mount them on the diagram, fasten tight clockwise, press tight the grinding cup with your hand, turn on the button switch for grinding
- When grinding sesame, walnut and other oily food, adding a spoon of granulated sugar into the grinding cup for grinding together will produce better results

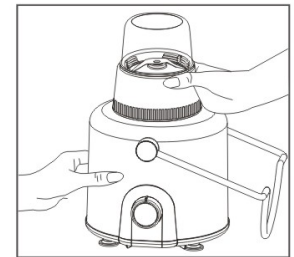

Note: in case of idling during grinding, i.e. when the cutter does not contact food, immediately stop, cut off power supply. Mix the food more softly, then turn on for grinding again.